

Statement of Information

Single residential property located in the Melbourne metropolitan area

Section 47AF of the Estate Agents Act 1980

Property offered for sale

Address Including suburb and postcode 86 Brunswick Road, Brunswick Vic 3056

Indicative selling price

For the meaning of this price see consumer.vic.gov.au/underquoting

Range between \$1,200,000 & \$1,250,000

Median sale price

Median price \$1,335,250 Property Type House Suburb Brunswick

Period - From 01/10/2025 to 31/12/2025 Source REIV

Comparable property sales (*Delete A or B below as applicable)

~~A* These are the three properties sold within two kilometres of the property for sale in the last six months that the estate agent or agent's representative considers to be most comparable to the property for sale.~~

Address of comparable property	Price	Date of sale
1		
2		
3		

OR

B* The estate agent or agent's representative reasonably believes that fewer than three comparable properties were sold within two kilometres of the property for sale in the last six months.

This Statement of Information was prepared on: 27/01/2026 10:26

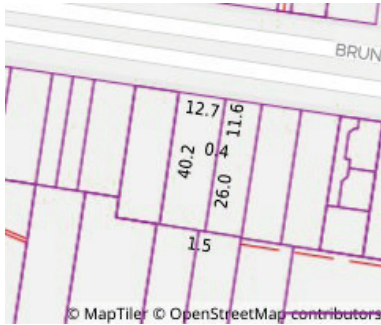

Property Type: House
Land Size: 498 sqm approx
Agent Comments

Indicative Selling Price
\$1,200,000 - \$1,250,000
Median House Price
December quarter 2025: \$1,335,250

No comparable sales, Large land opportunity at 498m2. House in need of renovation.

Comparable Properties

The estate agent or agent's representative reasonably believes that fewer than three comparable properties were sold within two kilometres of the property for sale in the last six months.