

STATEMENT OF INFORMATION

417/627 VICTORIA STREET, ABBOTSFORD, VIC 3067

PREPARED BY HERO THILAKARATNE, ZED REAL ESTATE, PHONE: 0423 254 756

STATEMENT OF INFORMATION

Section 47AF of the Estate Agents Act 1980

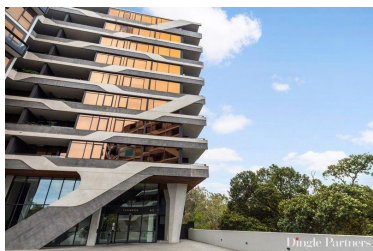

417/627 VICTORIA STREET,

 3  2  1

Indicative Selling Price

For the meaning of this price see consumer.vic.au/underquoting

Price Range: \$720,000 to \$790,000

Provided by: Hero Thilakaratne, Zed Real Estate

MEDIAN SALE PRICE

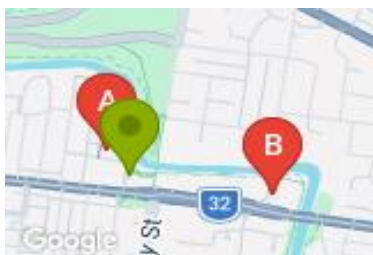

ABBOTSFORD, VIC, 3067

Suburb Median Sale Price (Unit)

\$535,000

01 January 2025 to 31 December 2025

Provided by: 

COMPARABLE PROPERTIES

The estate agent or agent's representative reasonably believes that fewer than three comparable properties were sold within two kilometres of the property for sale in the last six months.



1103/20 SHAMROCK ST, ABBOTSFORD, VIC

 3  2  2

Sale Price

Price Withheld

Sale Date: 04/02/2026

Distance from Property: 118m



703/4 ACACIA PL, ABBOTSFORD, VIC 3067

 3  3  3

Sale Price

****\$2,440,000**

Sale Date: 25/01/2026

Distance from Property: 470m



Statement of Information

Single residential property located in the Melbourne metropolitan area

Sections 47AF of the Estate Agents Act 1980

Instructions: The instructions in this box do not form part of this Statement of Information and are not required to be included in the completed Statement of Information for the property being offered for sale.

The Director of Consumer Affairs Victoria has approved this form of the Statement of Information for section 47AF of the *Estate Agents Act 1980*.

The estate agent or agent's representative engaged to sell the property is required to prepare this Statement of Information. It must be used when **a single residential property located in the Melbourne metropolitan area** is being offered for sale. The Determination setting out the local government areas that comprise the Melbourne metropolitan area is published on the Consumer Affairs Victoria website at **consumer.vic.gov.au/underquoting**. The indicative selling price in this Statement of Information may be expressed as a single price, or as a price range with the difference between the upper and lower amounts not more than 10% of the lower amount.

This Statement of Information must be provided to a prospective buyer within two business days of a request and displayed at any open for inspection for the property for sale.

It is recommended that the address of the property being offered for sale be checked at services.land.vic.gov.au/landchannel/content/addressSearch before being entered in this Statement of Information.

Property offered for sale

Address Including suburb and postcode: 417/627 VICTORIA STREET, ABBOTSFORD, VIC 3067

Indicative selling price

For the meaning of this price see consumer.vic.gov.au/underquoting

Price Range: \$720,000 to \$790,000

Median sale price

Median price: \$535,000 Property type: Unit Suburb: ABBOTSFORD
Period: 01 January 2025 to 31 December 2025 Source: pricfinder

Comparable property sales

The estate agent or agent's representative reasonably believes that fewer than three comparable properties were sold within two kilometres of the property for sale in the last six months.

Address of comparable property

Price

Date of sale

Address of comparable property	Price	Date of sale
1103/20 SHAMROCK ST, ABBOTSFORD, VIC 3067	Price Withheld	04/02/2026
703/4 ACACIA PL, ABBOTSFORD, VIC 3067	**\$2,440,000	25/01/2026

This Statement of Information was prepared on: 10/02/2026