

Statement of Information

Single residential property located in the Melbourne metropolitan area

Section 47AF of the Estate Agents Act 1980

Property offered for sale

Address Including suburb and postcode 36 Wheeler Street, Pascoe Vale South Vic 3044

Indicative selling price

For the meaning of this price see consumer.vic.gov.au/underquoting

Range between \$770,000 & \$830,000

Median sale price

Median price \$1,382,500 Property Type House Suburb Pascoe Vale South

Period - From 01/01/2026 to 31/03/2026 Source REIV

Comparable property sales (*Delete A or B below as applicable)

~~A* These are the three properties sold within two kilometres of the property for sale in the last six months that the estate agent or agent's representative considers to be most comparable to the property for sale.~~

Address of comparable property	Price	Date of sale
1		
2		
3		

OR

B* The estate agent or agent's representative reasonably believes that fewer than three comparable properties were sold within two kilometres of the property for sale in the last six months.

This Statement of Information was prepared on: 23/04/2026 09:05

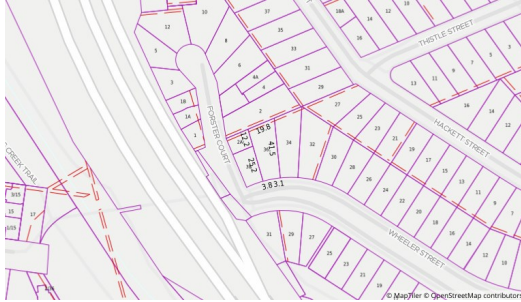

Property Type:

Divorce/Estate/Family Transfers

Land Size: 617 sqm approx

Agent Comments

Comparable Properties

The estate agent or agent's representative reasonably believes that fewer than three comparable properties were sold within two kilometres of the property for sale in the last six months.

Account - Jellis Craig Pascoe Vale | P: 03 9989 9575